

RIVKLE® Stainless steel blind rivet nuts

Hexagonal body, extra-small countersunk head

Typ 343 48

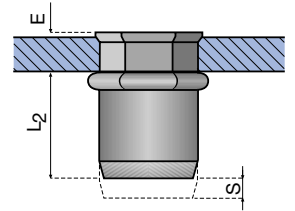
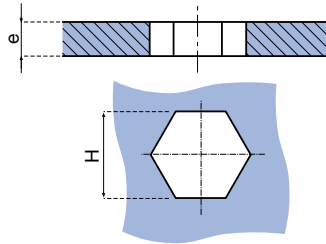
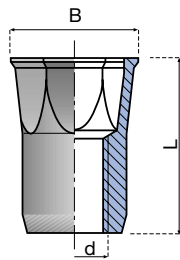
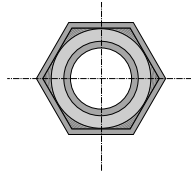

Advantages:

- very high turning resistance
- suitable for soft components (aluminium, plastic,...)
- very small head projection without countersinking
- high corrosion resistance
- screw length can be varied
- suitable for use in the food processing industry

d	Thickness e	Hole H ^{+01/0}	B	E _{max.}	S*	L	L ₂ *	B 71 301 Product code
M4	0.5 – 2.0	6	7.3	0.6	S = 3.5-e	10.6	6.8	3434 804 0020
M5	0.5 – 3.0	7	8.7	0.7	S = 3.8-e	11.6	7	3434 805 0020
M6	0.5 – 3.0	9	10.8	0.8	S = 5.2-e	14.5	9.5	3434 806 0025
M8	0.8 – 3.0	11	13.2	0.8	S = 5.5-e	15.8	10.2	3434 808 0030

* Dimensions S and L₂ are indicative values. The difference in length S depends on the material thickness and is used as the setting tool stroke.

Dimensions in mm. Other dimensions and variants can be supplied on request.



Hexagonal body, flat head

Typ 233 48

We now have RIVKLE® blind rivet nuts with part hexagonal body and flat round head available in M5, M6, M8 and M10 sizes.

Please contact us for further information.