

RIVKLE® Stainless steel blind rivet nuts

Round body, plain, extra-small countersunk head

Type 343 08 for holes with imperial dimensions
and type 343 68 for holes with metric dimensions

Advantages:

- very small head projection without countersinking
- high corrosion resistance
- screw length can be varied
- suitable for use in the food processing industry

For a newly developed application we recommend the use of type 343 68 for holes with metric dimensions.

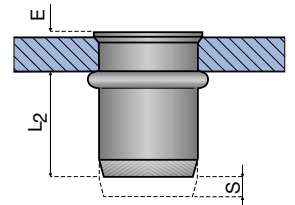
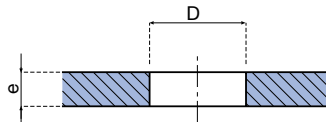
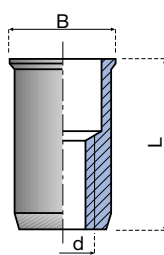

Typ 343 08

| d | Thickness e | Hole $D^{+0.1/0}$ | B | $E_{max.}$ | S^* | L | L_2^* | B 71 101 Product code |
|----|-------------|-------------------|------|------------|-------------|------|---------|-----------------------|
| M3 | 0.5 – 1.5 | 4.7 | 5.2 | 0.4 | $S = 2.8-e$ | 8.4 | 5.5 | 3430 803 0150 |
| M4 | 0.5 – 2.0 | 6.4 | 6.7 | 0.5 | $S = 3.5-e$ | 10.4 | 7.3 | 3430 804 0200 |
| M5 | 0.5 – 3.0 | 7.1 | 7.7 | 0.6 | $S = 4.5-e$ | 11.6 | 7.3 | 3430 805 0300 |
| M6 | 0.7 – 3.0 | 9.5 | 10.2 | 0.6 | $S = 5.7-e$ | 14.5 | 9.3 | 3430 806 0300 |
| M8 | 0.7 – 3.0 | 10.5 | 11.3 | 0.7 | $S = 5.7-e$ | 16.8 | 10.5 | 3430 808 0300 |

Typ 343 68

| d | Thickness e | Hole $D^{+0.1/0}$ | B | $E_{max.}$ | S^* | L | L_2^* | B 71 101 Product code |
|----|-------------|-------------------|----|------------|-------------|----|---------|-----------------------|
| M4 | 0.5 – 1.5 | 6 | 7 | 0.5 | $S = 3-e$ | 10 | 6.5 | 3436 804 0015 |
| M5 | 0.5 – 2.0 | 7 | 8 | 0.6 | $S = 4.5-e$ | 12 | 7 | 3436 805 0020 |
| M6 | 0.7 – 3.0 | 9 | 10 | 0.6 | $S = 5-e$ | 14 | 8.5 | 3436 806 0030 |
| M8 | 0.7 – 3.0 | 11 | 12 | 0.7 | $S = 5-e$ | 16 | 10.5 | 3436 808 0030 |

* Dimensions S and L_2 are indicative values. The difference in length S depends on the material thickness and is used as the setting tool stroke.

Dimensions in mm.

Other dimensions and variants can be supplied on request.